

Geometry – Unit 1 Practice
Constructing Congruent Angles

G.CO.D.12

Name: _____!

Date: _____ Pd: _____

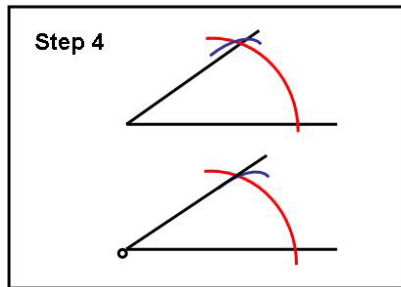
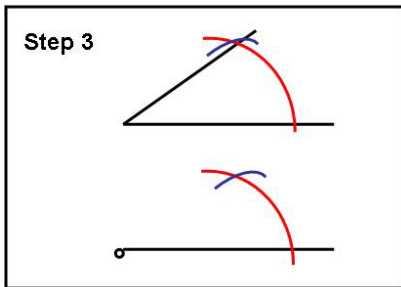
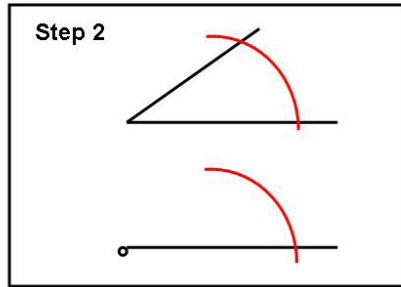
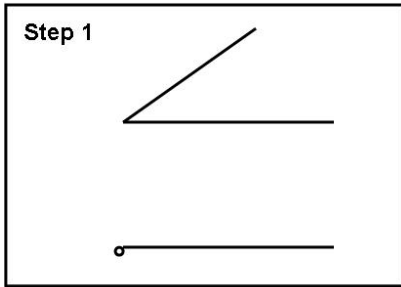

- Create one side of your angle by drawing a ray.
- Mark an arc on the given angle and an equal arc from the initial point on your ray.
- Using the compass “measure” the distance between the arc intersections on the given angle.
- Without changing the compass, mark the same distance on your drawing.
- Connect your initial point with your intersection point.

1) Use the “copy an angle” construction to verify that $\angle G \cong \angle Q$.

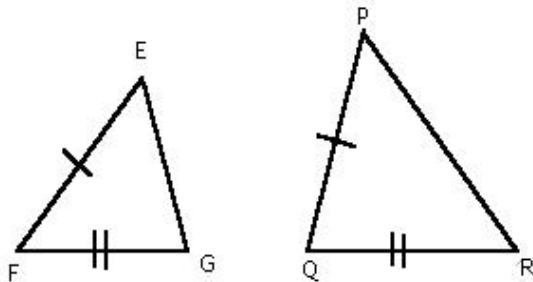

2) Use the “copy an angle” construction to verify that $\angle 1 \cong \angle 8$.

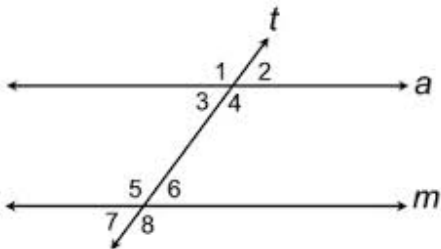

3) Construct congruent angles:

a)

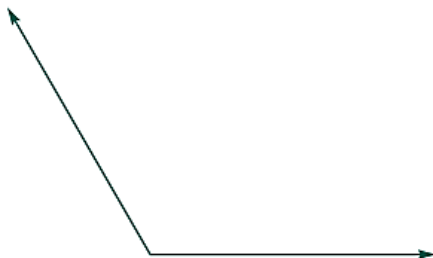

b)

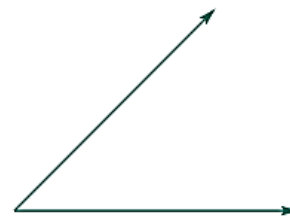



4) Explain in your own words how to construct an angle that is the sum of two given angles.

5) Construct an angle that is twice the measure of the given angle.

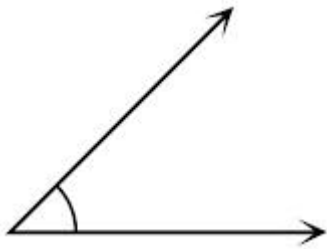

6) Construct an angle that is the difference of the given angles.

